



**Scottish
Water**

Trusted to serve Scotland

Keeping you in the picture

Protecting the natural environment in your area

If you have any questions about Scottish Water and our services, please visit www.scottishwater.co.uk, or call our Customer Helpline on 0800 0778778

Growth project at Kiltarlity WwTW

New 35m2 Sludge Holding Tank

A new sludge holding tank will replace the existing tank. The sludge tank is emptied weekly and transported for further processing at a separate location.

New Storm Tank

Storm water occurs during periods of high rainfall. This results in highly diluted sewage which could cause problems to the treatment process. During storm events stormwater is directed to a new storm tank. The storm tank retains the storm water until the high rainfall period has passed. Integral pumps are used to empty the stormwater tank after the high rainfall event has passed. As the flow is passed forward and not back to the inlet works in this case.

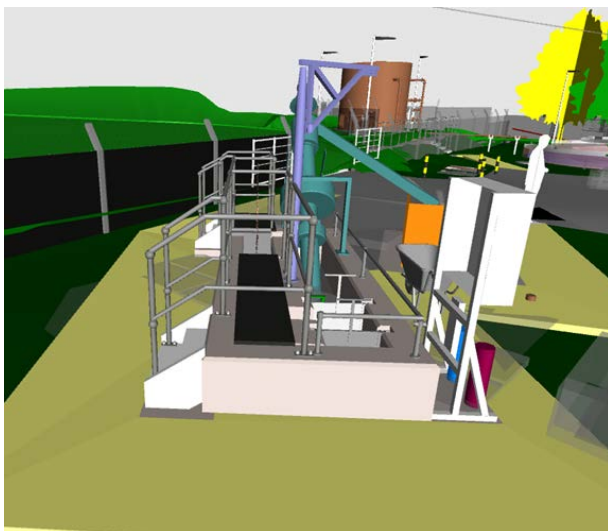
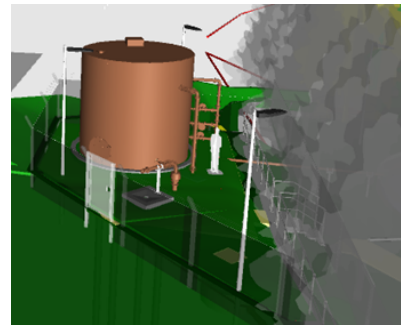

Inlet Works

The inlet works is the first stage of the wastewater treatment process. Gross solids which are made up of inorganic materials such as sand, silt and glass are removed at this stage to prevent blockages in the treatment system.

The inlet works at Kiltarlity is to be fully replaced with a new system.